

# HIQ Lighting Control - HIQ LCS

## Concept

HIQ LCS is a system of integrated devices and software for lighting automation. The primary function is control and management of any lights - on/off, dimmable, LED RGB, LED stripes using local wired or wireless push or touch buttons, Wi-Fi tablets, Mobile phones or BMS/SCADA monitoring and control. Lights can be controlled by scenarios, scheduled, by motion sensors using direct relay modules, DALI, DSI or PWM/Triac dimmable and LED stripes. Although the basic concept of HIQ LCS is simple, the possibility to extend current capabilities or add new is unlimited.

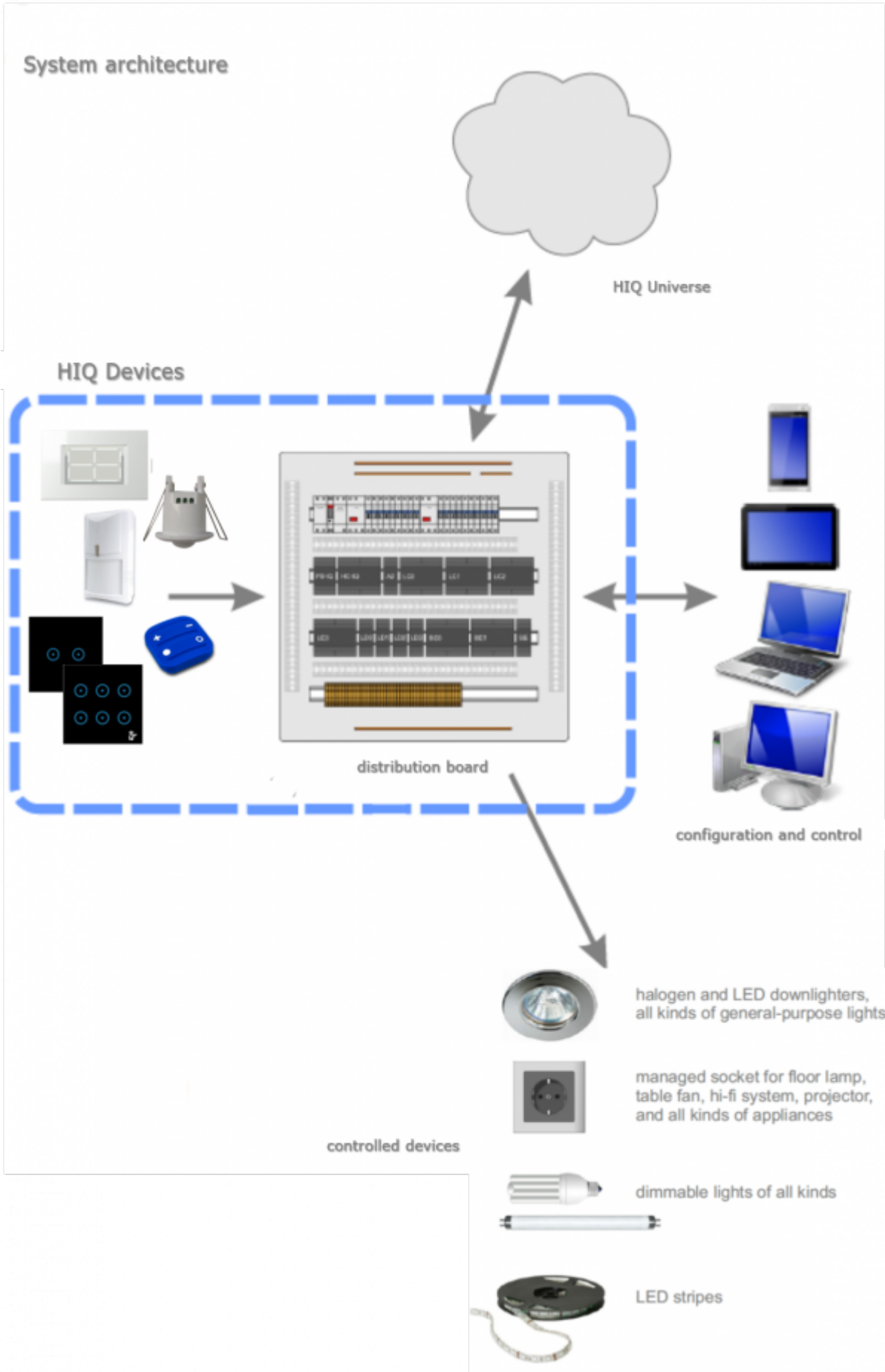

From:

<https://wiki.hiq-home.com/> -

Permanent link:

[https://wiki.hiq-home.com/doku.php?id=en:ms\\_main:hiq\\_lighting:concept](https://wiki.hiq-home.com/doku.php?id=en:ms_main:hiq_lighting:concept)

Last update: **2020/05/10 19:39**

